

- NOTES:
- 1) B.L. Information, if shown, was obtained from applying record plat or local agencies and is not guaranteed by NTT, Inc.
 - 2) Building line and/or Flood Zone information is subject to the interpretation of the engineer.
 - 3) NTT, Inc. does not certify to unknown or unrecorded encroachments or overlaps.
 - 4) Property markers NOT found, or guaranteed by this location.
 - 5) Setback distance accuracy: 3'±.

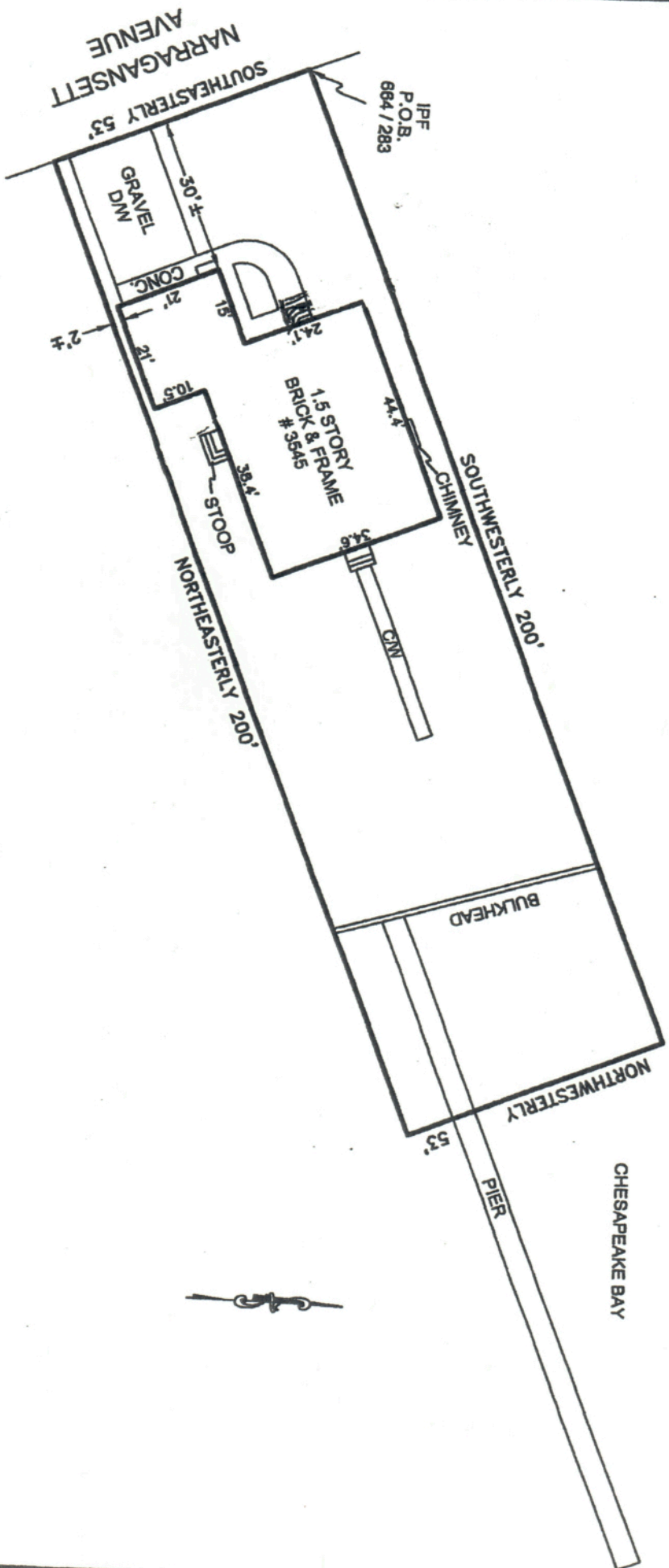

Subject property is shown in Zone AB & V10 on the FIRM Map of Anne Arundel County Maryland on Community Panel 240008 0044 C . Effective MAY 2, 1983

This is to certify that I have surveyed the property shown hereon, being known as
 PART OF BLOCK 11
 ARUNDEL ON THE BAY
 and recorded among the land records of Anne Arundel County Maryland in Liber 664 , folio 283
 for the purpose of locating the improvements thereon.

* This plat is of benefit to the consumer only insofar as it is required by a lender or a title insurance company or its agent in connection with contemplated transfer, financing, or refinancing purposes.
 * This plat is not to be relied upon for the establishment of location of fences, garages, buildings, or other existing or future structures.
 * This plat does not provide for the accurate identification of property boundary lines, but such identification may not be required for the transfer of title or for securing financing or refinancing.



J. Carl Hudgins PLS #96

LOCATION DRAWING
 3545 NARRAGANSETT AVENUE
 2ND ELECTION DISTRICT
 ANNE ARUNDEL COUNTY, MARYLAND

NTT Associates, Inc.
 16205 Old Frederick Road
 Mt. Airy, Maryland 21771
 Ph. (410)442-2031
 Fax No. (410)442-1315

Scale:	1" = 30'
Date:	11/9/08
Field By:	RJJ
Drawn By:	RJJ
Drawing #	10984APS